

ES WINDOWS, INC.
PREMIDOR 88MM VINYL LIFT AND SLIDE DOOR LMI
LARGE MISSILE IMPACT

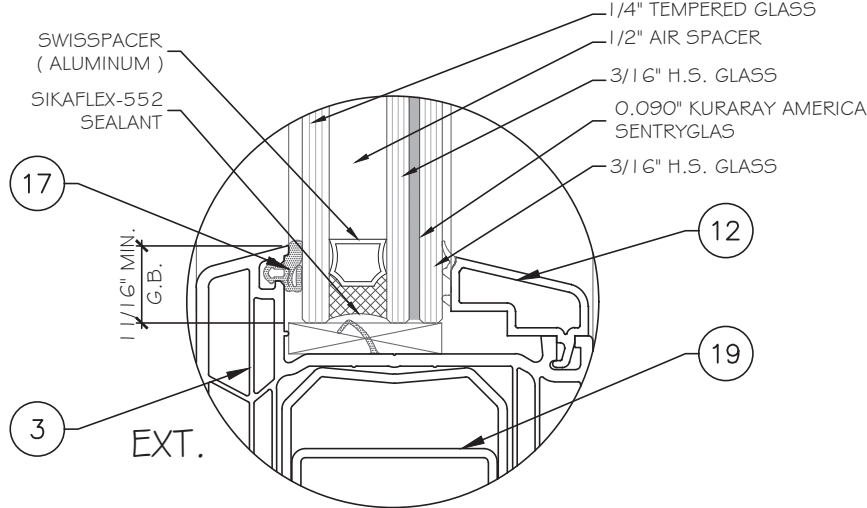

INSULATED LAMINATED GLASS BY ST. GOBAIN
 3/16" NOMINAL OVERALL

GENERAL NOTES:

- THIS PRODUCT HAS BEEN DESIGNED AND TESTED TO COMPLY WITH THE REQUIREMENTS OF THE 8TH EDITION FLORIDA BUILDING CODE (2023) INCLUDING HIGH VELOCITY HURRICANE ZONE (HVHZ).
- PRODUCTS ARE RATED FOR LARGE MISSILE IMPACT. IMPACT SHUTTERS ARE NOT REQUIRED.
- PRODUCTS ARE APPROVED FOR AIR AND WATER INFILTRATION.
- ANCHORS SHALL BE AS LISTED, SPACED AS SHOWN ON DETAILS. ANCHORS EMBEDMENT TO BASE MATERIAL SHALL BE BEYOND WALL DRESSING OR STUCCO.
- ANCHORING OR LOADING CONDITIONS NOT SHOWN IN THESE DETAILS ARE NOT PART OF THIS APPROVAL.
- MATERIALS INCLUDING BUT NOT LIMITED TO STEEL / METAL SCREWS THAT COME INTO CONTACT WITH OTHER DISSIMILAR MATERIALS SHALL MEET THE REQUIREMENTS OF THE 8TH EDITION FLORIDA BUILDING CODE (2023) SECTION AS APPLICABLE.
- WOOD BUCKS AND METAL STRUCTURES BY OTHERS TO BE DESIGNED TO SUPPORT THE LOADS IMPOSED BY THIS GLAZING SYSTEM AND TO TRANSFER SUCH LOADS TO THE BUILDING MAIN STRUCTURE.
- ULTIMATE LOAD OBTAINED FROM ASCE 7-22, MULTIPLY BY 0.6 SHALL BE LESS THAN OR EQUAL TO MAX. DESIGN LOAD IN THIS DOCUMENT. THE DESIGN LOADS SHOWN IN THIS DOCUMENT ARE ALLOWABLE DESIGN LOADS.
- ALL JOINT AND FRAME CONNECTION SEALED WITH SILICONE SEALANT.
- MANUFACTURER'S LABEL SHALL BE LOCATED ON A READILY VISIBLE LOCATION IN ACCORDANCE WITH SECTION 1709.9.3 OF FLORIDA BUILDING CODE LABELING TO COMPLY WITH SECTION 1709.9.2.

NOTE:
 GLASS COMPLIES WITH ASTM E1300-16
 (3 SEC. GUSTS).

INSTRUCTIONS:

USE CHARTS AS FOLLOWS.

- STEP 1:** DETERMINE DESIGN WIND LOAD REQUIREMENTS BASED ON WIND VELOCITY, BLDG. HEIGHT, WIND ZONE USING APPLICABLE ASCE 7-22 STANDARD.
- STEP 2:** SEE SHEET E1 FOR APPROVED TYPICAL ELEVATION.
- STEP 3:** SEE SHEET COVER FOR GLASS TYPE.
- STEP 4:** ANCHOR OPTION SEE SHEET A1. ANCHOR LAYOUT SEE ELEVATION.
- STEP 5:** THE LOWEST VALUE RESULTING FROM STEPS 2, 3 AND 4 SHALL APPLY TO ENTIRE SYSTEM.

ABBREVIATIONS AND SYMBOLS	
G.B. - GLASS BITE	
D.L.O. - DAYLITE OPENING	
F.H. - FRAME HEIGHT	
F.W. - FRAME WIDTH	
W/ - WITH	
W/O - WITHOUT	
O.C. - ON CENTER	

LIMITATIONS OF USE

A- THIS PRODUCT EVALUATION DOCUMENT (P.E.D.) PREPARED BY THIS ENGINEER IS GENERIC AND DOES NOT PROVIDE INFORMATION FOR A SITE SPECIFIC PROJECT; I.E. WHERE THE SITE CONDITIONS DEVIATE FROM THE P.E.D.

B- CONTRACTOR TO BE RESPONSIBLE FOR THE SELECTION, PURCHASE AND INSTALLATION OF THIS PRODUCT BASED ON THIS PRODUCT EVALUATION PROVIDED HE/SHE DOES NOT DEVIATE FROM THE CONDITIONS DETAILED ON THIS DOCUMENT.

C- THIS PRODUCT EVALUATION DOCUMENT WILL BE CONSIDERED INVALID IF ALTERED BY ANY MEANS.

D- SITE SPECIFIC PROJECTS SHALL BE PREPARED BY A FLORIDA REGISTERED ENGINEER OR ARCHITECT WHICH WILL BECOME THE ENGINEER OF RECORD (E.O.R.) FOR THE PROJECT AND WHO WILL BE RESPONSIBLE FOR THE PROPER USE OF THE P.E.D.

E- THIS P.E.D. SHALL BEAR THE DATE AND ORIGINAL SEAL AND SIGNATURE OF THE PROFESSIONAL ENGINEER OF RECORD THAT PREPARED IT.

FL44619.2

April 30, 2024

MCY ENGINEERING, INC.
 GLAZING CONSULTANTS
 12781 MIRAMAR PARKWAY #301
 MIRAMAR, FL 33027 P: 305.271.0117
 www.MCYEngineering.com mcy@mcyengineering.com

PREMIDOR 88MM VINYL LIFT AND SLIDE DOOR OXXO-L.M.I.
ES WINDOWS, INC.
 3550 N.W. 49 STREET
 Miami, FL 33142
 TEL: (305) 638-5151 EMAIL: ssabagh@energiasolar.com

Rev. No.	Date	Drawn By	Description
1.	01.11.2024	JAMES	NEW APPLICATION

Drawn Date: 01.11.2024 Scale: _____

DRAWING NO.
AD24-03

COVER

Sheet No.
01 OF 9

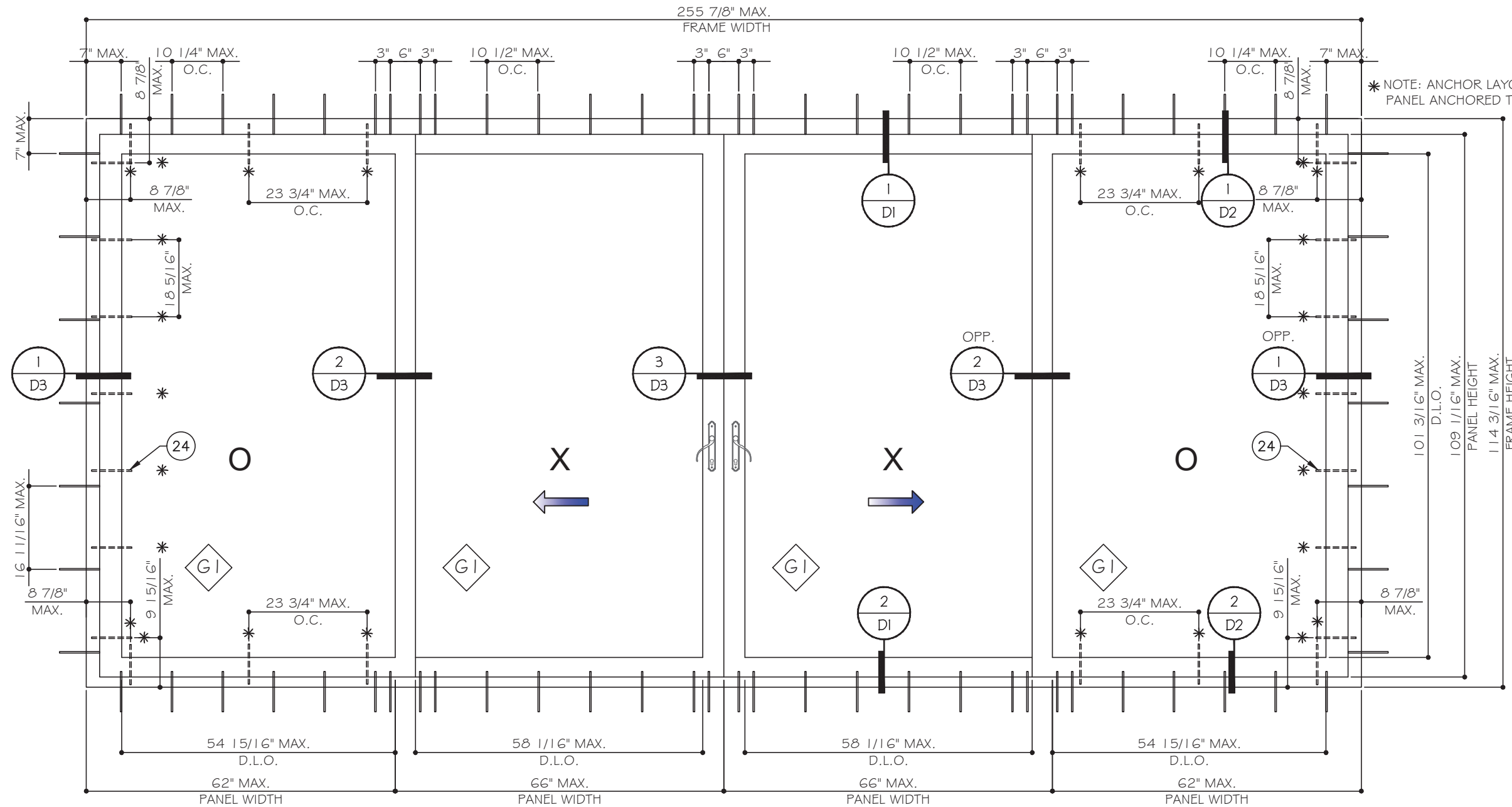

* NOTE: ANCHOR LAYOUT FOR FIXED PANEL ANCHORED TO THE FRAME.

TYPICAL EXTERIOR ELEVATION (OXXO)
SEE ANCHOR OPTION & ANCHOR CHART ON SHEET A I

DESIGN LOAD CAPACITY - PSF		
DESIGN LOAD	GLASS TYPE	MISSILE IMPACT RATEING
PSF		
±55	G1	LARGE AND SMALL MISSILE IMPACT RATED

NOTE: MISSILE LEVEL D, WIND ZONE 4 AND HVHZ.
FOR SIZE SHOWN ABOVE OR SMALLER AS PERMITTED BY FBC.

FL44619.2

YIRNG WANG
PROFESSIONAL ENGINEER
STATE OF FLORIDA
LICENSE NO. 55989

MCY ENGINEERING, INC.
GLAZING CONSULTANTS
12781 MIRAMAR PARKWAY #301
MIRAMAR, FL 33027
P: 305.271.0117
www.MCYEngineering.com mcy@mcyengineering.com

PREMIDDOOR 88MM VINYL LIFT AND SLIDE DOOR OXXO-L.M.I.
ES WINDOWS, INC.
3550 N.W. 49 STREET
Miami, FL 33142
TEL. (305) 638-5151 EMAIL: ssabagh@energiasolar.com

Rev. No.	Date	Drawn By	Description
1.	01.11.2024	JAMES	NEW APPLICATION

Drawn Date: 01.11.2024 Scale: _____

DRAWING NO. AD24-03

Sheet No. E1

02 OF 9

April 30, 2024

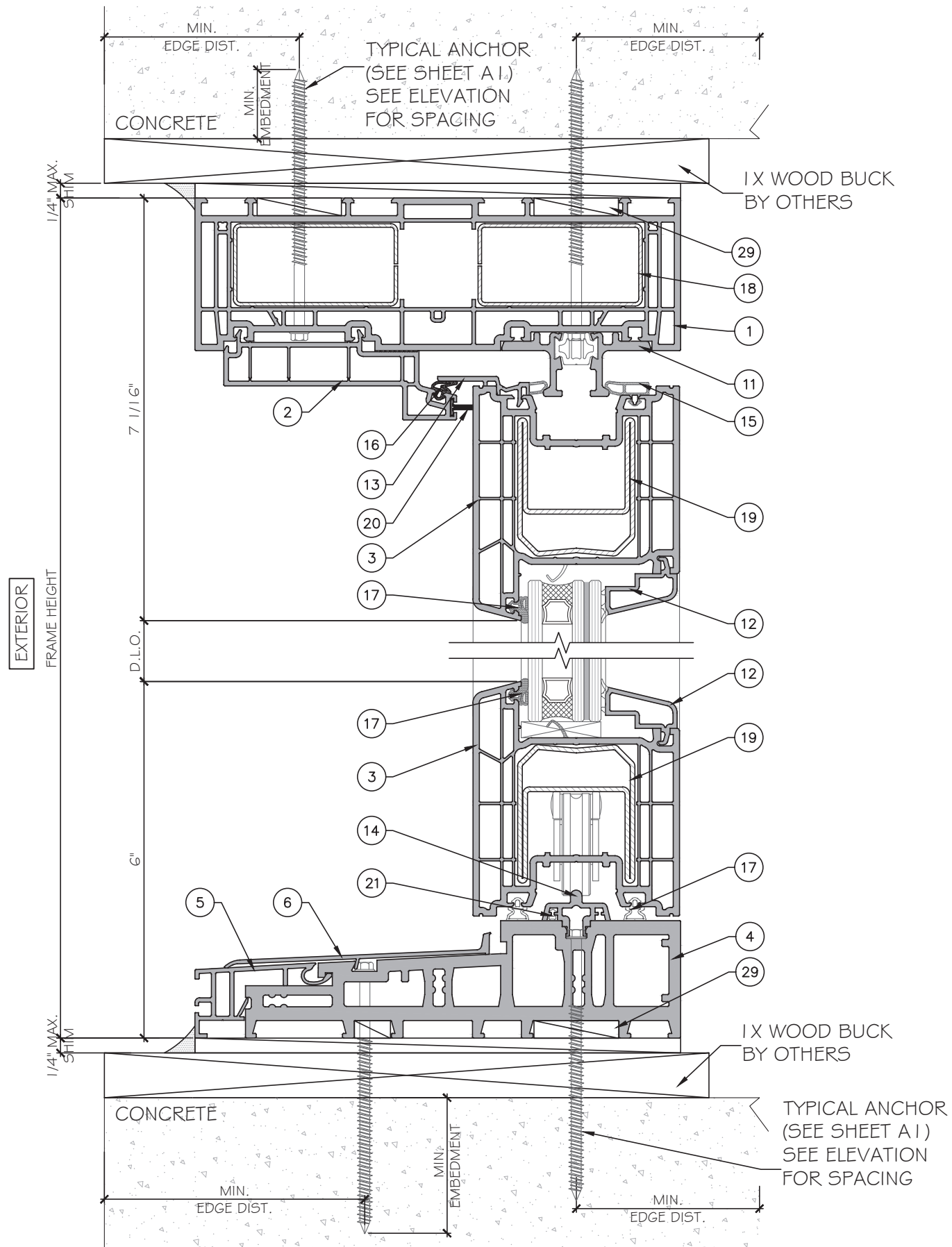

1
D1
DETAIL

2
D1
DETAIL

FL44619.2

YIRNG WANG
PROF. REGISTRATION
L.A.N. 28677
No 55989
STATE OF FLORIDA
PROFESSIONAL ENGINEER

April 30, 2024

MCY ENGINEERING, INC.
GLAZING CONSULTANTS
12781 MIRAMAR PARKWAY #301
MIRAMAR, FL 33027 P: 305.271.0117
www.MCYEngineering.com mcy@mcyengineering.com

PREMIDDOOR 88MM VINYL LIFT AND SLIDE DOOR OXXO-L.M.I.
ES WINDOWS, INC.
3550 N.W. 49 STREET
Miami, FL 33142
TEL. (305) 638-5151 EMAIL: ssabagh@energiasolarsa.com

Rev. No.	Date	Drawn By	Description
1	01.11.2024	JAMES	NEW APPLICATION

Drawn Date: 01.11.2024 Scale: _____

DRAWING NO. AD24-03

Sheet No. 03 OF 9

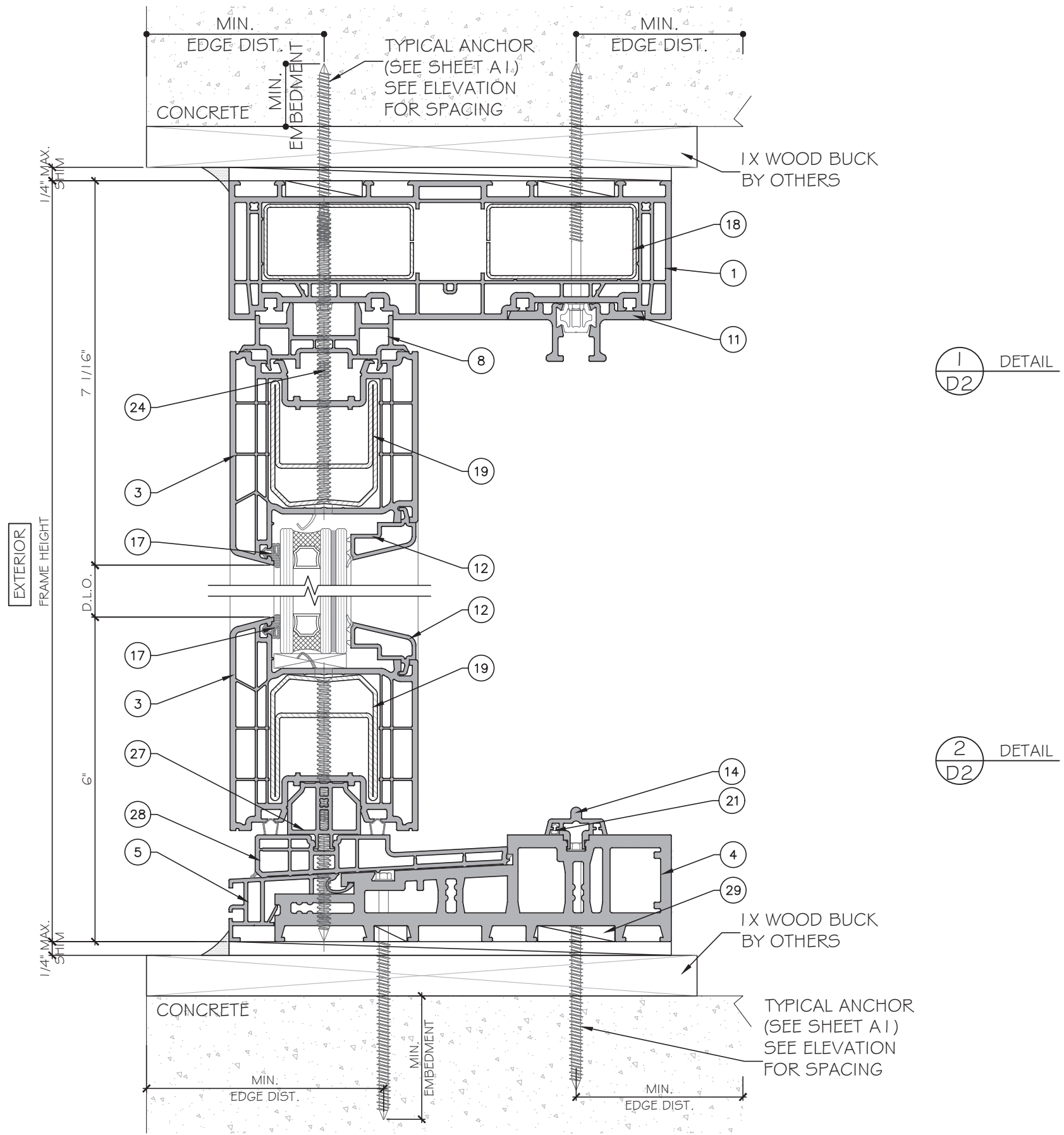

1
D2
DETAIL

2
D2
DETAIL

FL44619.2

YIRNG WANG
 PROFESSIONAL ENGINEER
 LICENSE NO. 55983
 STATE OF FLORIDA

April 30, 2024

MCY ENGINEERING, INC. GLAZING CONSULTANTS 12781 MIRAMAR PARKWAY #301 MIRAMAR, FL 33027 P: 305.271.0117 www.MCYEngineering.com mcy@mcyengineering.com			
PREMIDOR 88MM VINYL LIFT AND SLIDE DOOR OXXO-L.M.I. ES WINDOWS, INC. 3550 N.W. 49 STREET Miami, FL 33142 TEL. (305) 638-5151 EMAIL: ssabagh@energiasolar.com			
Rev. No.	Date	Drawn By	Description
1.	01.11.2024	JAMES	NEW APPLICATION
Drawn Date	Scale	DRAWING NO.	
01.11.2024		AD24-03	
Sheet No.		04 OF 9	

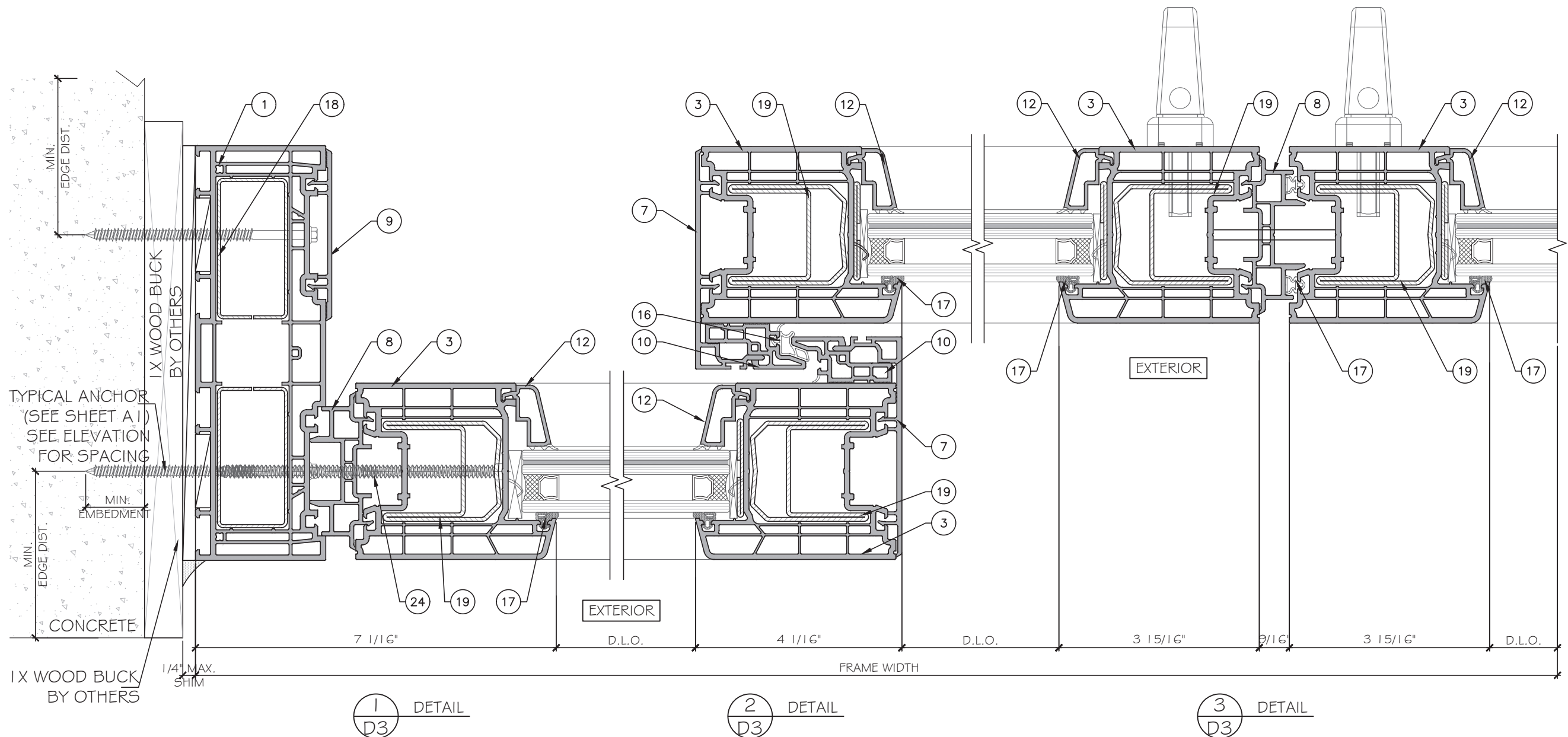

1
D3
DETAIL

2
D3
DETAIL

3
D3
DETAIL

FL44619.2

YIRNG WANG
 PROFESSIONAL REGISTRATION
 No. 55983
 L.A.N. 28677

STATE OF FLORIDA
 PROFESSIONAL ENGINEER

April 30, 2024

MCY ENGINEERING, INC.
 GLAZING CONSULTANTS
 12781 MIRAMAR PARKWAY #301
 MIRAMAR, FL 33027 P: 305.271.0117
 www.MCYEngineering.com mcy@mcyengineering.com

PREMIDOR 88MM VINYL LIFT AND SLIDE DOOR OXXO-L.M.I.
ES WINDOWS, INC.
 3550 N.W. 49 STREET
 Miami, FL 33142
 TEL. (305) 638-5151 EMAIL: ssabagh@energiasolar.com

Rev. No.	Date	Drawn By	Description
1.	01.11.2024	JAMES	NEW APPLICATION

Drawn Date: 01.11.2024 Scale: _____

DRAWING NO. AD24-03

Sheet No. D3

05 OF 9

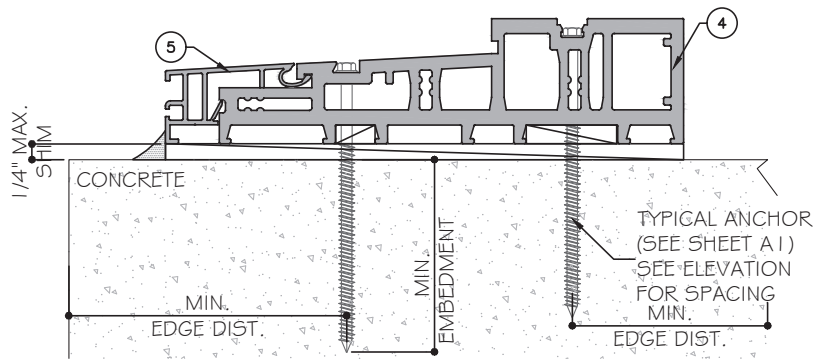
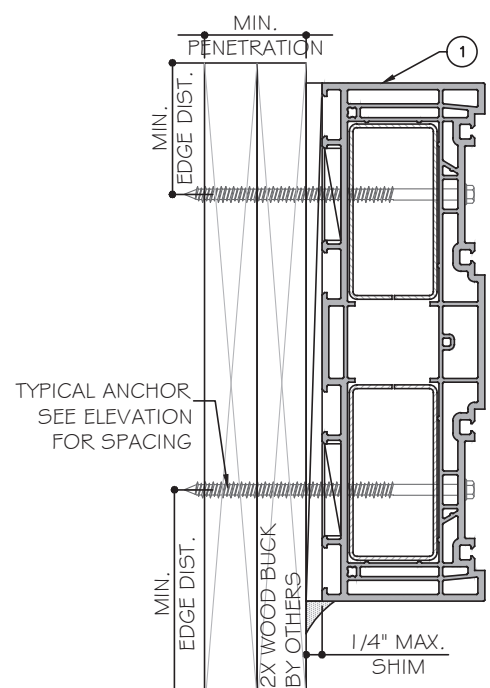
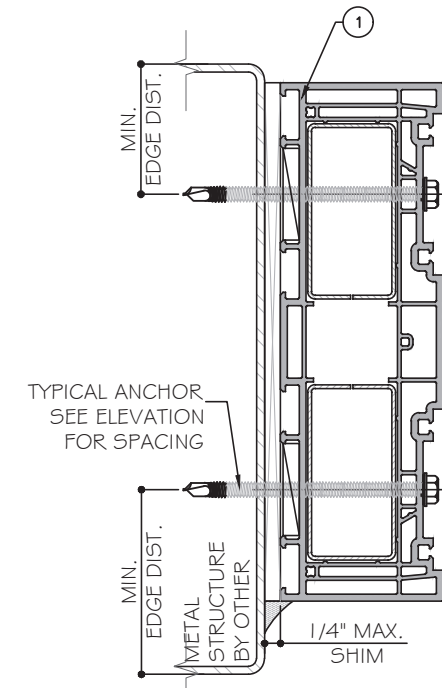
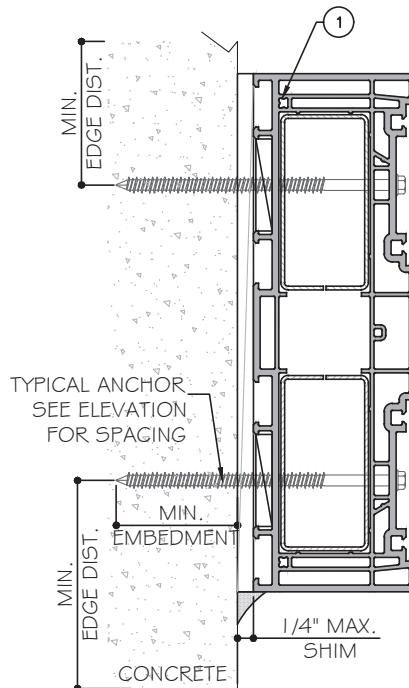
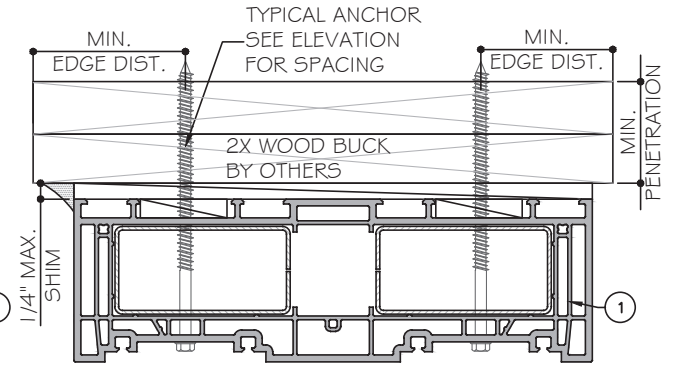
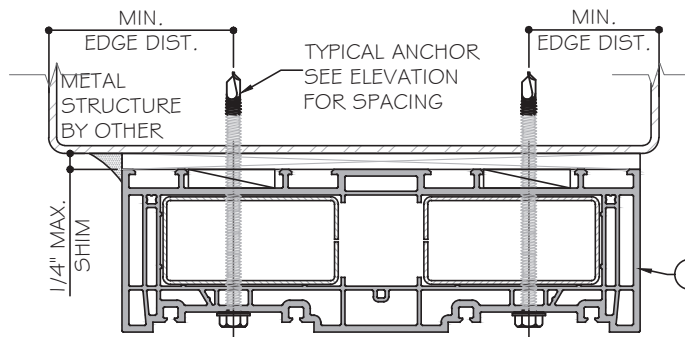
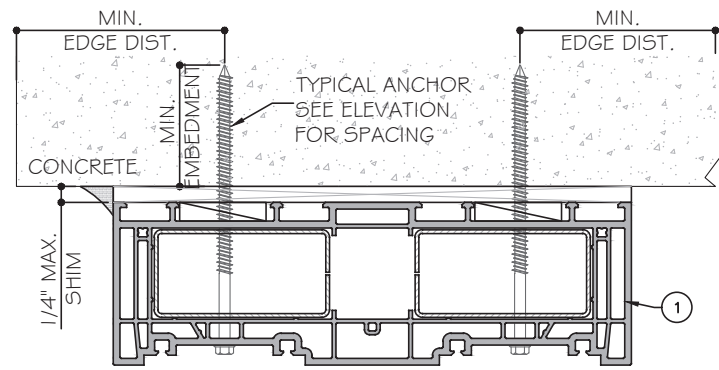

TYPICAL ANCHOR TYPES

ANCHOR TYPE 'A' - 1/4" DIA. ULTRACON+ BY 'DEWALT' (Fu=164KSI, Fy=148KSI) INTO 2BY WOOD BUCKS / WOOD STRUCTURE WITH 1 1/2" MIN. PENETRATION INTO WOOD. (HEAD / JAMB)

OR THRU 1BY WOOD BUCKS INTO CONCRETE OR BLOCKS 1 3/4" MIN. EMBED INTO CONCRETE (HEAD/ JAMB/ SILL) 1 3/4" MIN. EMBED INTO BLOCKS (JAMBS)

DIRECTLY INTO CONCRETE OR BLOCKS 1 3/4" MIN. EMBED INTO CONCRETE (HEAD/ JAMB/ SILL) 1 3/4" MIN. EMBED INTO BLOCKS (JAMBS)

ANCHOR TYPE 'B' - 1/4" TEKS OR SELF-DRILLING SCREWS (GRADE 5 CR5) INTO F.B.C. APPROVED MULLIONS OR INTO METAL STRUCTURES. (HEAD/ JAMB) (3) THREADS MIN. PENETRATION BEYOND METAL SUBSTRATE.

ANCHOR EDGE DISTANCE:
 INTO WOOD STRUCTURE: 1" MIN.
 INTO CONCRETE: 2 1/2" MIN.
 INTO METAL STRUCTURE: 3/4" MIN.

SUBSTRATE:
 WOOD: SG = 0.55 MIN.
 CONCRETE: f_c = 3 KSI MIN.
 C-90 HOLLOW / FILLED BLOCK: f_m=2 KSI MIN.
 ALUMINUM: 1/8" THK. MIN. (6063-T5, MIN.)
 STEEL: 16GA THK. MIN. ASTM A653 GRADE 33 (F_y=33KSI) MIN.
 (STEEL IN CONTACT WITH ALUMINUM TO BE PLATED OR PAINTED)

1X OR 2X WOOD WOOD BUCKS BY OTHERS TO BE DESIGNED TO SUPPORT THE LOADS IMPOSED BY THIS GLAZING SYSTEM AND TO TRANSFER SUCH LOADS TO THE BUILDING MAIN STRUCTURE.

FL44619.2

YIRNG WANG
 PROFESSIONAL REGISTRATION
 No. 55983
 L.A.N. 28677

STATE OF FLORIDA
 PROFESSIONAL ENGINEER

April 30, 2024

Rev. No.	Date	Drawn By	Description
1.	01.11.2024	JAMES	NEW APPLICATION

Drawn Date: 01.11.2024 Scale: _____

DRAWING NO. AD24-03

Sheet No. A1

06 OF 9

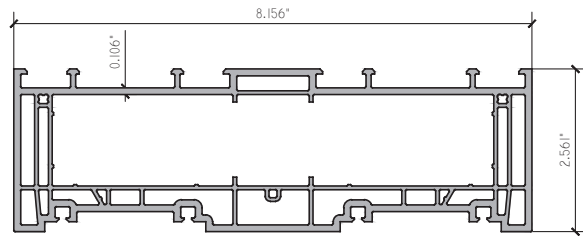

1 MAIN FRAME
2880 RIGID VINYL

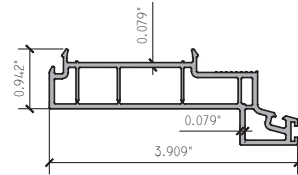

2 FRAME COVER
2881 RIGID VINYL

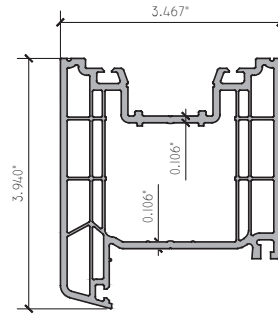

3 SASH PROFILE
2883 RIGID VINYL

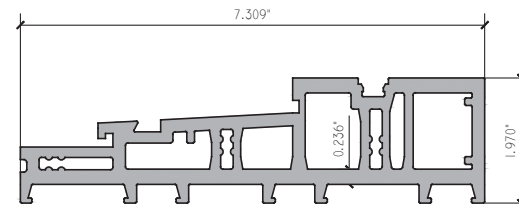

4 FRAME THRESHOLD
9579 RIGID VINYL

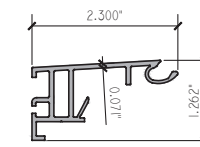

5 CONNECTOR
9572 ALUM. 6063-T5

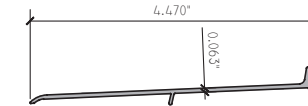

6 SILL COVER
9576.2 ALUM. 6063-T5

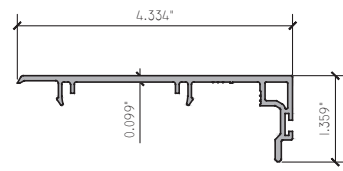

7 COVER PROFILE
2886 ALUM. 6063-T5

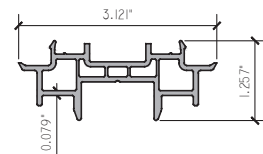

8 SPACING PROFILE
2885 ALUM. 6063-T5

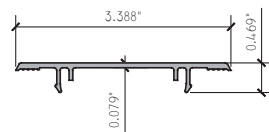

9 COVER PROFILE
2882 ALUM. 6063-T5

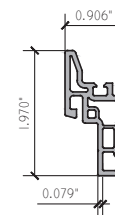

10 MIDDLE CONNECTOR
2887 ALUM. 6063-T5

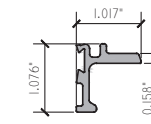

11 CONNECTOR ADAPTOR
9588 ALUM. 6063-T5

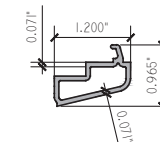

12 GLAZING BEAD
76501.3 RIGID VINYL

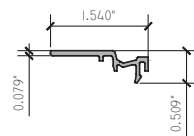

13 CONNECTOR PROFILE
185563 ALUM. 6063-T5

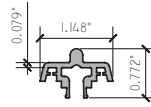

14 ROLLING TRACK
9577/9578 ALUM. 6063-T5

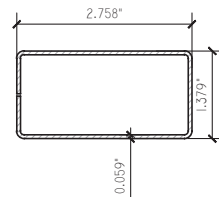

18 FRAME REINFORCEMENT
V191 GALV.STL.

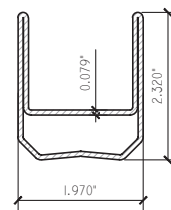

19 SASH REINFORCEMENT
V192 GALV.STL.

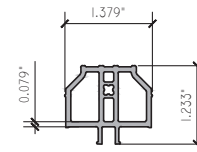

27 BOTTOM RAIL
MO85 RIGID VINYL

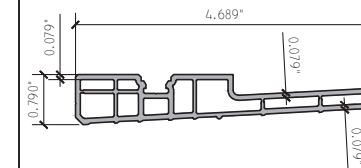

28 BOTTOM FRAME
2884 RIGID VINYL

FL44619.2

YIRING WANG
PROFESSIONAL REGISTRATION
No. 55989
L.A.N. 28677

STATE OF
FLORIDA
PROFESSIONAL ENGINEER

April 30, 2024

MCY ENGINEERING, INC.
GLAZING CONSULTANTS
12781 MIRAMAR PARKWAY #301
MIRAMAR, FL 33027 P: 305.271.0117
www.MCYEngineering.com mcy@mcyengineering.com

PREMIDOR 88MM VINYL LIFT AND SLIDE DOOR OXXO-L.M.I.
ES WINDOWS, INC.
3550 N.W. 49 STREET
Miami, FL 33142
TEL. (305) 638-5151 EMAIL: ssabagh@energiasolarsa.com

Rev. No.	Date	Drawn By	Description
1.	01.11.2024	JAMES	NEW APPLICATION

Drawn Date: 01.11.2024 Scale: _____

DRAWING NO. AD24-03

Sheet No. M1 07 OF 9

BILL OF MATERIALS

ITEM NO.	PARTS NUMBERS	DESCRIPTION	MATERIAL	MANUFACTURER
1	2880	MAIN FRAME, RIGID VINYL	RIGID VINYL	PROFINE
2	2881	FRAME COVER, RIGID VINYL	RIGID VINYL	PROFINE
3	2883	SASH PROFILE, RIGID VINYL	RIGID VINYL	PROFINE
4	9579	FRAME THRESHOLD, RIGID VINYL	RIGID VINYL	PROFINE
5	9572	CONNECTOR, 6063 T5 ALUMINUM	6063-T5 ALUM.	PURCHASE
6	9576.2	SILL COVER, 6063 T5 ALUMINUM	6063-T5 ALUM.	PURCHASE
7	2886	COVER PROFILE, 6063 T5 ALUMINUM	6063-T5 ALUM.	PURCHASE
8	2885	SPACING PROFILE, 6063 T5 ALUMINUM	6063-T5 ALUM.	PURCHASE
9	2882	COVER PROFILE, 6063 T5 ALUMINUM	6063-T5 ALUM.	PURCHASE
10	2887	MIDDLE CONNECTOR, 6063 T5 ALUMINUM	6063-T5 ALUM.	PURCHASE
11	9588	CONNECTOR ADAPTOR, 6063 T5 ALUMINUM	6063-T5 ALUM.	PURCHASE
12	76501.3	GLAZING BEAD, RIGID VINYL	RIGID VINYL	PROFINE
13	185563	CONNECTOR PROFILE, 6063 T5 ALUMINUM	6063-T5 ALUM.	████████
14	9577/9578	ROLLING TRACK, 6063 T5 ALUMINUM	6063-T5 ALUM.	████████
15	G030_KU	GASKET TPE, EPDM DUR 70	EPDM	████████
16	G034_KU	GASKET, 80 DUROMETER EPDM	EPDM	PURCHASE
17	G032_KU	GASKET, 80 DUROMETER EPDM	EPDM	PURCHASE
18	V191	FRAME REINFORCEMENT, GALV.STL.	GALV. STL.	PURCHASE
19	V192	SASH REINFORCEMENT, GALV.STL.	GALV. STL.	PURCHASE
20	G057	GASKET, 80 DUROMETER EPDM	EPDM	PURCHASE
21	G043	GASKET, 80 DUROMETER EPDM	EPDM	PURCHASE
22	V192	SASH REINFORCEMENT, GALV. STL.	GALV. STL.	PURCHASE
23	████████	#6 X 0.875 PH. FHD SCREW	STAINLESS STEEL	████████
24	████████	AMO III 7.5MM DIA. CYLINDER HEAD SCREW, VARIABLE LENGTH BASED ON USAGE	STAINLESS STEEL	WURTH *
25	PURCHASE	#14 PH OR FH WOOD INSTALLATION SCREW	STAINLESS STEEL	████████
26	PURCHASE	1/4" DIAM.HH OR FH I.T.W. MASONRY ANCHOR	STAINLESS STEEL	I.T.W.
27	M085	BOTTOM RAIL. RIGID VINYL	RIGID VINYL	PROFINE
28	2884	BOTTOM FRAME. RIGID VINYL	RIGID VINYL	PROFINE
29	-	SOLID SHIM	████████	████████

MCY ENGINEERING, INC.
 GLAZING CONSULTANTS
 12781 MIRAMAR PARKWAY #301
 MIRAMAR, FL 33027 P: 305.271.0117
 www.MCYEngineering.com mcy@mcyengineering.com

PREMIDDOOR 88MM VINYL LIFT AND SLIDE DOOR OXXO-L.M.I.
ES WINDOWS, INC.
 3550 N.W. 49 STREET
 Miami, FL 33142
 TEL. (305) 638-5151 EMAIL: ssabagh@energiasolarsa.com

FL44619.2

YIRNG WANG
 PROFESSIONAL REGISTERED ENGINEER
 LICENSE NO. 55989
 STATE OF FLORIDA
 APRIL 30, 2024

Rev. No.	Date	Drawn By	Description
1.	01.11.2024	JAMES	NEW APPLICATION
Drawn Date	01.11.2024	Scale	
DRAWING NO.			
AD24-03			
M2			
Sheet No.			
08 OF 9			

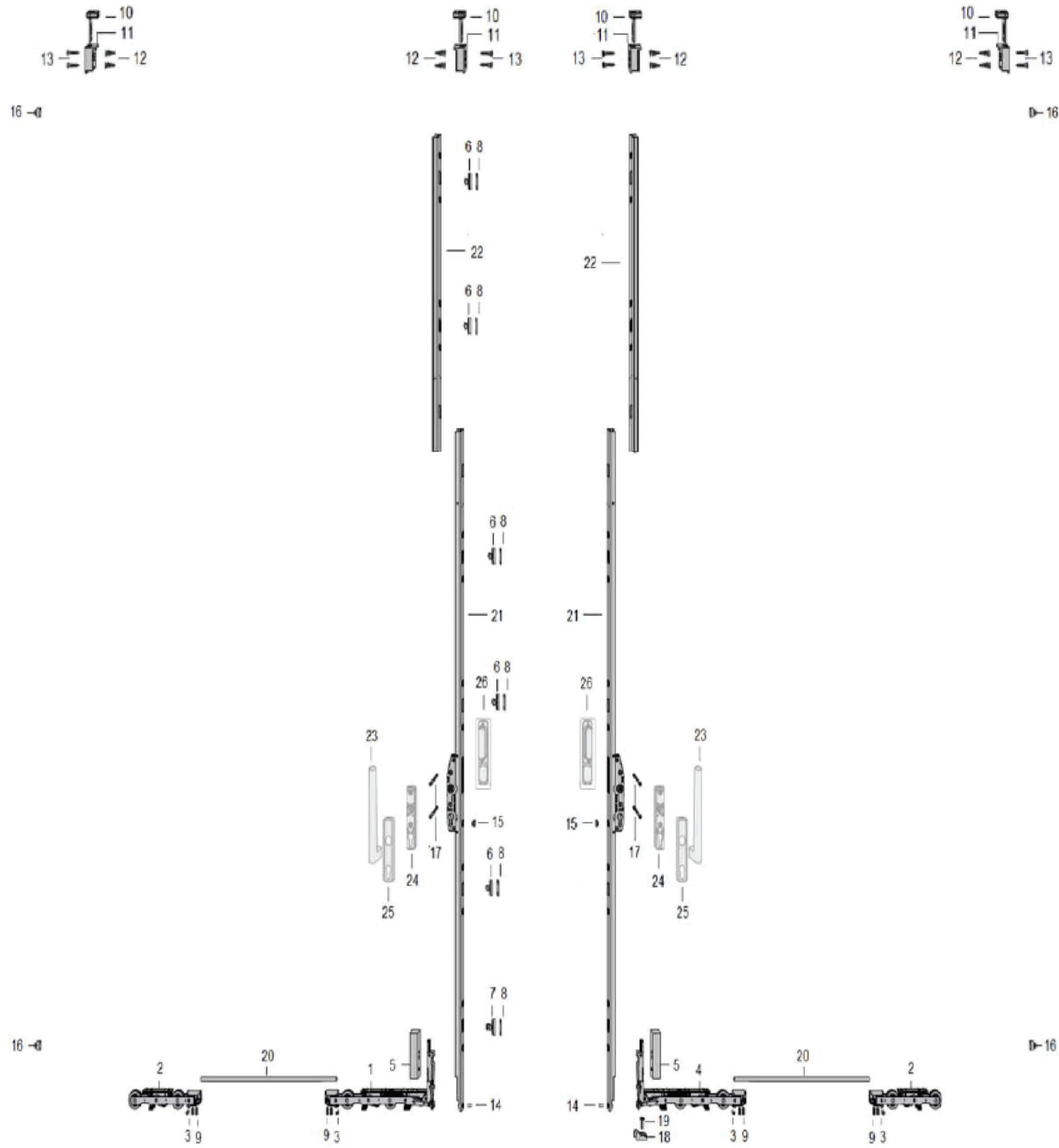

BILL OF MATERIALS			
ITEM NO.	DESCRIPTION	MATERIAL	MANUFACTURER
1	CORNER DRIVE VSU HS300 SCHEME A	BASIC KIT PORTAL-HS 300 SCHEME A	PMKBO300
2	REAR BOGIE HS300		
3	BRUSH SEALING		
4	CORNER DRIVE VSU HS300 SCHEME C	BASIC KIT PORTAL-HS 300 SCHEME C	PMKBO310
2	REAR BOGIE HS300		
3	BRUSH SEALING		
5	DISTANCE PIECE A0008	ADDITIONAL KIT PORTAL-HS 300 SCHEME C PREMIDOOR	PMZB4180
6	LOCKING PIECE TOP A0005		
7	LOCKING PIECE BOTTOM A0005		
8	PACKER 1mm		
9	GRUB SCREW M8 X 16		
10	GUIDING PIECE		
11	GUIDING PART		
12	SCREW ANCHOR		
13	CLAMPING SCREW 4.5 X 45		
14	COUNTERSUNK SCREW PZD M5 X 13		
15	COVER CAP		
16	BUFFER		
17	COUNTERSUNK SCREW K/PSD M5 X 95		
18	LOCKING PART G	-	PGKBO030
19	TAPPING SCREW B 6.3X38	-	PMGBO010
20	CONNECTING ROD D10 SZ. 200	-	PV5E0060
21	GEAR PORTAL-HS 300 PZ SZ 260	-	PGKBO030
22	ADDITIONAL LOCK HS	-	PMGBO010
23	HANDLE HS 300 SI-LINE	KIT HANDLE SI-LINE PORTAL-HS 300	PMHBO010
24	ROSETTE SI-LINE HS 300		
25	COVER CAP SI-LINE HS 300		
26	SLIDING GRIP SI-LINE		

FL44619.2

April 30, 2024

MCY ENGINEERING, INC.
GLAZING CONSULTANTS
12781 MIRAMAR PARKWAY #301
MIRAMAR, FL 33027
P: 305.271.0117
www.MCYEngineering.com mcy@mcyengineering.com

ES WINDOWS, INC.
3550 N.W. 49 STREET
Miami, FL 33142
TEL. (305) 638-5151 EMAIL: ssabagh@energiasolar.com

Rev. No.	Date	Drawn By	Description
1.	01.11.2024	JAMES	NEW APPLICATION

Drawn Date	Scale
01.11.2024	

DRAWING NO.
AD24-03

M3

Sheet No.
09 OF 9